



HARMONY

ZA-14

Massage Chair

Operating Instruction



[Http://www.zenawakening.com/](http://www.zenawakening.com/)



Galaxy Home Design
7813 East Admiral Place
Tulsa, OK 74115
Phone number 918-835-1166

Please read "Safety Instruction" carefully before operating.

HARMONY ZA-14 Massage Chair

Thanks for buying HARMONY ZA-14 massage chair, read users manual first of all.
Keep the manual in case later use and pay attention to "Safety Instruction".

Note: We reserve the right of designing modification and interpretation. It's subjected to change without notice. As to the color, please refer to the real chair.

Content

Function Instruction	1
Safety Instruction	1
Installation	5
External structure name	7
Manual of remote control	8
Operating Instruction and function illustration	12
FAQ and troubleshooting data	14
Technical parameter	14
Schematics of mechanical parts	15
Mechanical parts list	16







Please keep the manual in safe place for future reference.

Function Instruction









1. The back part of massage chair used RK02 massage machine has achieved national patent of invention. It can effect rolling, massaging, kneading, knocking, tapping and over ten massage on head, neck, back, waist, buttock, etc. Which can meet acupoints, relieve fatigue and promote blood circulation.
2. Air pressure massage on legs parts and seating part can relieve fatigue and promote blood circulation.
3. Heating function in footrest and seat makes you enjoy massage in warm. It can promote blood circulation and relieve fatigue.
4. Two-section legrest. It can stretched and retracted for 10cm and fits for people in different height range.
5. Novel design makes the chair attractive.
6. New LCD screen remote control.
7. Two electric actuators control the back part and legs parts separately, which makes the legs and back being adjusted to any angle. It also has legs stretch function.
8. New massage skill makes you feel more comfortable.

Safety Instruction







- Read users manual first of all, install and use the massager according to the requests in the manual.
- "Safety Instruction" is made into two terms of WARNING and CAUTION. Remember to unplug the massager if not in use. Please close all the massage function before unplugging the chair.
- Make sure that power switch is at "OFF" position before inserting the plug into the socket.

 WARNING	This sign indicates "warning of causing possible death, hurt to body"		
 CAUTION	This sign indicates "caution of causing possible hurt, damage to things"		
	This sign indicates "forbidden behavior"		This sign indicates "self disassembly is forbidden"
	This sign indicates "must follow instruction to operate"		This sign indicates "cable right handling"

Safety Instruction

 WARNING	
	<ul style="list-style-type: none"> Children and babies are not allowed to use the massager. Before using the chair, if you feel abnormal or abnormal phenomenon occurs, please consult doctor to avoid any accident or bad effects to your body. Make sure to unplug the power, turn off all the massge functions and switch before unplugging the power.
	<ul style="list-style-type: none"> Make sure there is no people or anything around (under, behind or in front of) the chair when using backrest, legrest up/down or legrest extension function.
	<ul style="list-style-type: none"> Please pay attention to the massage rollers' situation. You couldn't have much strong massage on head.
	<ul style="list-style-type: none"> Before use, please check carefully if there is any defective cloth, for any minor broken cloth, please unplug the power and have it repaired instead of continuous use.
	<ul style="list-style-type: none"> Children are not allowed to operate the chair, nor sit or stand on the backrest or armrest. Those who can't express himself/herself or can't operate the chair by himself are not allowed to use it in case of any accident or hurt.
	<ul style="list-style-type: none"> Power cord, plug, socket can not be used in broken or loose contact condition.
	<ul style="list-style-type: none"> Don't use the power except rated voltage power in case of fire, electric shock or any breakdown.

Safety Instruction

 WARNING	
	<ul style="list-style-type: none"> Any broken, re-process, twist, stretch or heavy cargo on the power cable (especially under this chair) isn't allowed. Don't twist the cushion or other spare parts in case of short circuit, fire or electric shock.
	<ul style="list-style-type: none"> For any breakdown of the chair, make sure to have it repaired by professional repairman, self-modification, disassembly or maintenance is forbidden.. If power cord is damaged, please don't replace it by yourself, please contact us or appointed dealer for replacement.
 CAUTION	
	<ul style="list-style-type: none"> Please use the massager in a flat place. Please check if the massager heads are in correct position before you sit on the chair to avoid any possible accident or hurt. It is suggested that every operation time is within 15mins and max. 5 mins massage for one position, and please begin with slight-step massage; long time continuous massage on same position may cause uncomfortable feeling. Please turn off the switch behind the massager after use to prevent children from playing on it. For sake of safety, please insert the plug into the socket with earth  wire; the plug or earth wire can not be bended or removed in case of electric leakage or shock.
	<ul style="list-style-type: none"> Don't press the massage rollers with hands or step them on. Don't put hands between the working massage heads. Don't put hands or feet between mechanical parts. Don't stand or sit or lay anything on the backrest, armrest or legrest. Don't move the chair during it is working. Don't put your head and hands between or under legrest. Don't use the chair while wearing hard hair decorations. No any hard things inside the pockets when massaging hip or thighs. Don't pull out plug or turn off switch during operation.

Safety Instruction



CAUTION

	<ul style="list-style-type: none"> • Don't sleep while using the chair. • For drunk people or those who feel uncomfortable, please don't use the chair.
	<ul style="list-style-type: none"> • No water, dust or other waste things is available on the power plug; otherwise it may cause fire, electric shock or short circuit.
	<ul style="list-style-type: none"> • Operating the massage chair on heating items like electric heat blanket is strictly forbidden otherwise it may cause fire.
	<ul style="list-style-type: none"> • Be careful not to drop or embed anything into the slot of massage chair in case of any damage to it.
	<ul style="list-style-type: none"> • Don't put the chair in direct sunlight, or close to stove, heating machine system; otherwise it may fade leather surface.
	<ul style="list-style-type: none"> • Don't use or store massagers in wet place like swimming pool, bathroom, etc. • Keep the controllers and chairs dry, don't touch plug with wet hands in case of electric shock or hurt.
	<ul style="list-style-type: none"> • Please turn off the switch immediately when electricity is off in case of any possible accident or hurt when the power is on again.
	<ul style="list-style-type: none"> • Please be sure to take PLUG out of the socket instead of holding power cord to unplug it otherwise the plug may drop or cause electric shock troubles.
	<ul style="list-style-type: none"> • Don't touch the power plug with wet hands when repairing or cleaning the chair that need to pull out the plug, or it will cause electric shock or injury.

<p>Cleaning</p>	<ul style="list-style-type: none"> • For normal use, clean it with dry cloth, chemical detergent is not allowed to use. • For dirt or dust, please clean it with soft cloth with warm water or with neutral detergent, then reclean it with trusted dry cloth, let it dry naturally, don't clean it with diluent of alcohol or gasoline.
-----------------	--

<p>Grounding illustration Replace the fuse</p>	<p>The chair is equipped with earth plug cable. The plug must be insert into the socket that is well installed, linked with earth and adapt to this plug.</p> <p>When the fuse is blown, please unplug the power and turn off the switch, then open the cap of fuse box which on the switch box with screwdriver to replace the fuse in the same standards, at last installing the cap of fuse or let the electrician help to replace it.</p>
--	---

<p>Earth wire is not allowed here</p>	<p>Gas pipe: probably cause explosion or fire. Phone wire and lightning rod: probably cause electric shock or fire when thundering. Water pipe: earth wire is useless where there are plastics.</p>
---------------------------------------	---

Installation

1. Open the carton and take out massager.

Cut the packing strings with knife slightly, take out all accessories and massager. There must be no less than 2 people to handle the chair.

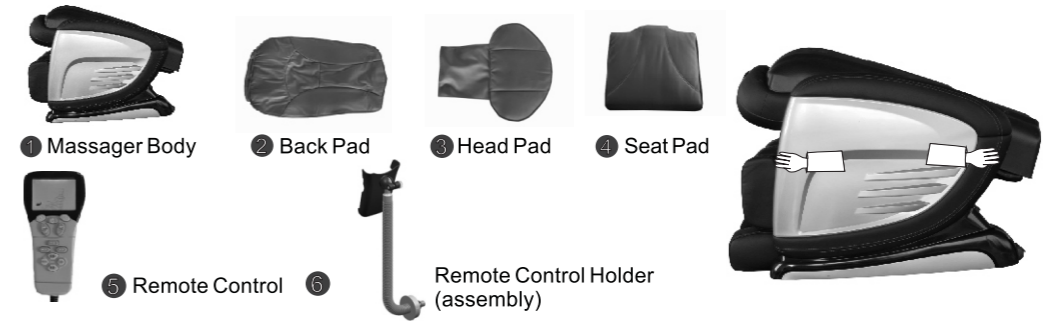

3. Connect air tubes in seat pad and frame.

Connect the air tubes in seat pad and seat frame. Tubes which are with tendon connect with "L" connector, without tendon connect with "T" connector. Then taping the velcro on seat pad and frame together.

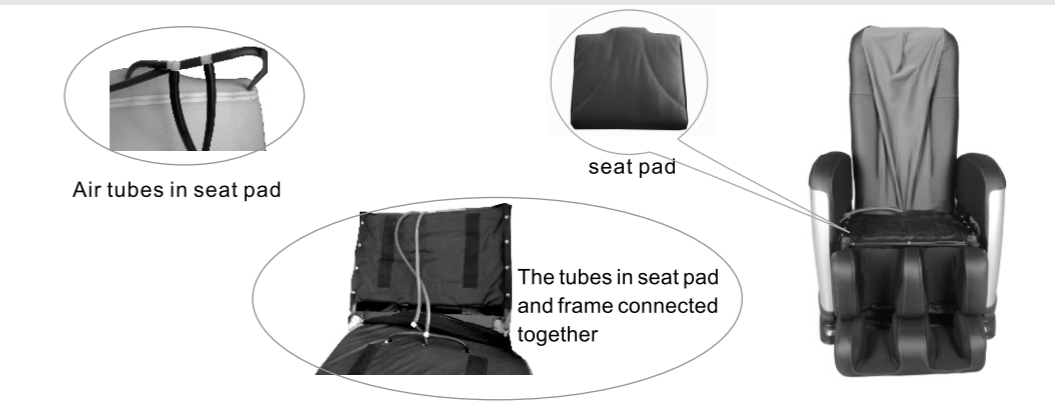

Installation

4. Connect back pad, pillow with backrest.

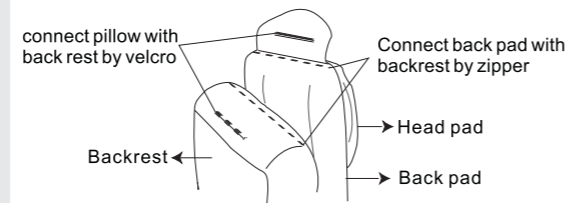

6. Installing ZA-14 remote control holder

Take out remote control and holder, install the holder at the right side of massager, put the controller in the holder.

7.1). Please check the surroundings before turning on the power

- 1)). Check if there are any objects behind the chair.
- 2)). Check if there is enough space (at least 40cm) behind the chair to recline freely.

2). Check the chair

- 1)). Check if there is a cleft on head pad, central back pad. Also check cloth material.

- 2)). Check if there is damage on the power cable or any dust on plug.

3). Turn on the power

- 1)). Make sure the voltage conforms with the required specification of the chair.

- 2)). Connect the plug with socket.

- 3)). Turn on the switch under the backrest, 1 means ON, 0 means OFF. Choose massage with controller and enjoy the comfortable massage.

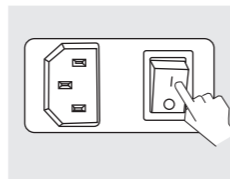
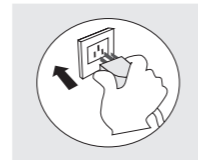

External structure name



Manual of remote control

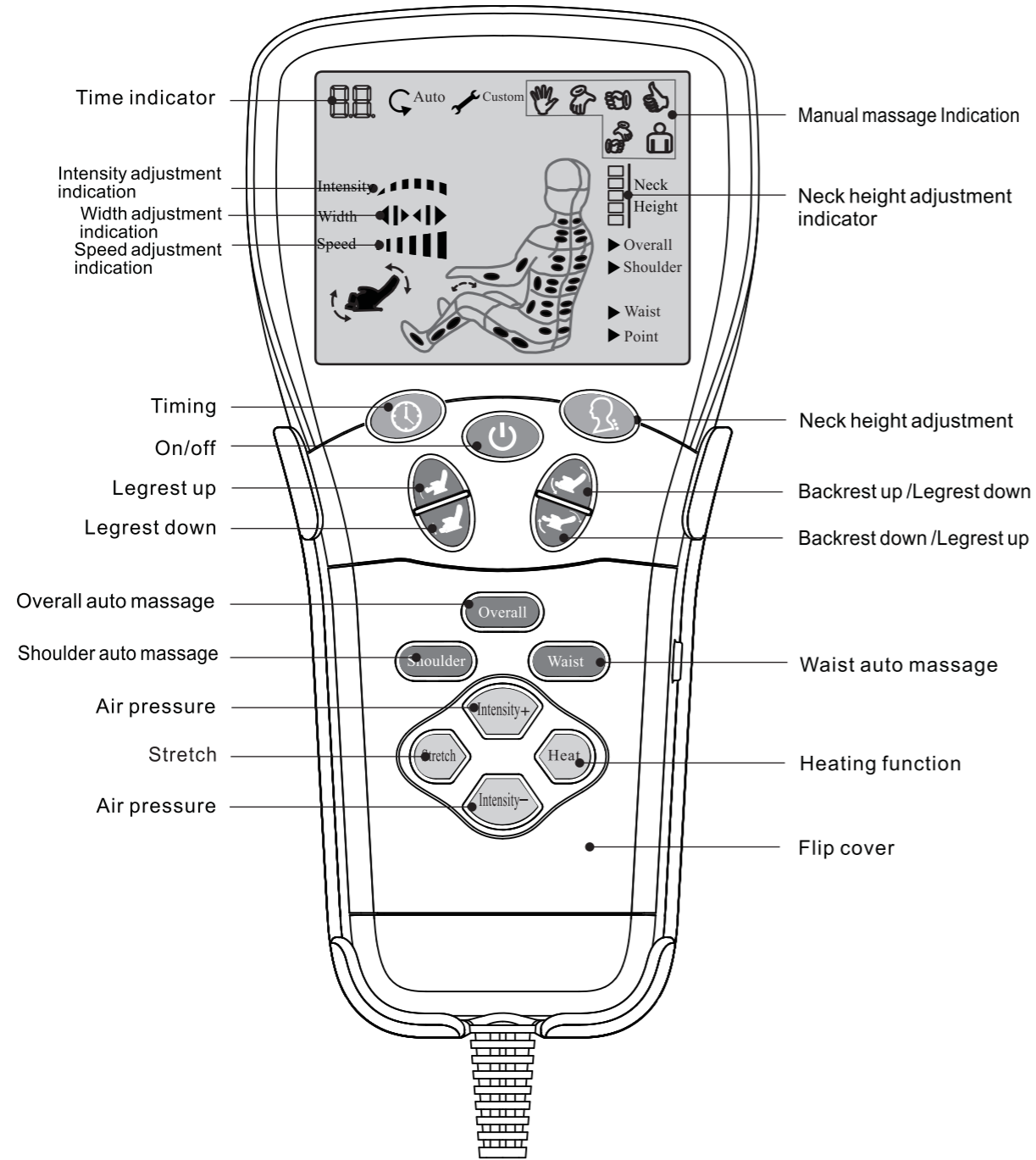

Close the cover

Manual of remote control

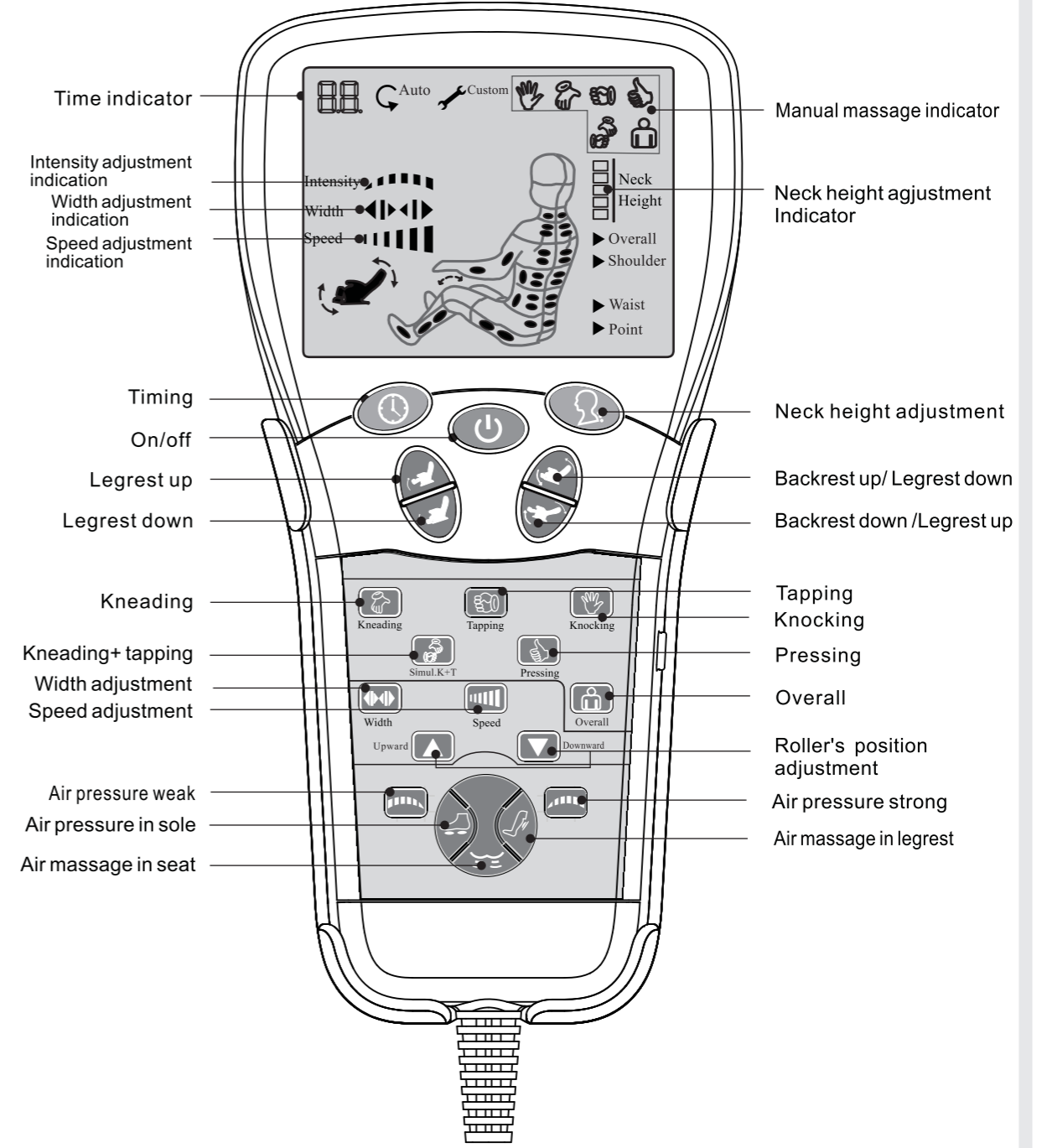

Open the cover

Manual of remote control

- All of the massage function can be operated by the remote control. Before use, please make sure that there are no children or pets nearby the chair.
- If the operation is correct, buzzer will send out one beep sound. If the operation is incorrect, it will have no sound.



- Press on/off key to turn on or turn off the power
Turning on the power, time shows 15 mins, the backrest will go down while the legrest is going up till comfortable setting angle, press other keys to start the massager function.
When turning off the power or setting time is up, time on the LCD screen shows 00, the backrest will go up while the legrest is going down to original angle, the LCD back light will go out in ten seconds.



- Press "neck's height adjustment" key
Adjust rollers' top position according to your body height in case massage motion hurt user's head, five heights available.



- Time setting key, the original time is 15 mins, press this key, it will show 10, 15, 20, 25, 30mins.



- Electric actuator (adjustable in auto or manual mode)
- ✦ Keep pressing the key, the legrest will go up; release the key, the legrest will stop going up.



- ✦ Keep pressing the key, the legrest will go down; release the key, the legrest will stop going down.



- ✦ Keep pressing the key, the backrest will go up while the legrest is going down; release the key, the backrest and the legrest will stop going up/down.



- ✦ Keep pressing the key, the backrest will go down while the legrest will go up; release the key, the backrest and the legrest will stop going up/down.



- Keys for auto massage
(available only when the remote control flip cover is closed)



Massage the full back in automatic mode;



Massage shoulders in automatic mode;



Massage waist in automatic mode;



Leg stretch and automatic air pressure are available at this moment.

- Air pressure massage (adjustable in auto and manual mode)

✦ Press "HEAT" key to start or stop heating in seat (waist) and sole.

✦ Press "STRETCH" key to start or stop air pressure with stretch function in legs.

✦ Press the two keys under air pressure massage to choose air pressure massage intensity, there are 3 intensities for choice. The corresponding indication will light on the screen accordingly.

Manual of remote control

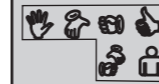

- Keys for manual massage
(available only when the remote control flip cover is open)

Massage machine:

Press any key in the manual area such as kneading, tapping, pressing, kneading+tapping, knocking or overall key to enjoy comfortable massage, the indicator on remote control screen will come on accordingly.



- ✦ Kneading: Rhythmical strong kneading-relaxation. Especially for relaxation of stiff muscles.



- ✦ Tapping: It gives feeling like fists to eliminate muscle stiffness.



- ✦ Knocking: Imitating palms of massage doctors to knock stiff muscles intermittently.



- ✦ Kneading +tapping: Combine kneading with tapping perfectly and completely.



- ✦ Pressing: Imitates thumbs of professional massage doctors to press on special points, especially for point massage on muscle pain.



- ✦ Overall massage: Roll on the whole back to stretch fatigue muscles.
Notes: entire course massage combining with kneading, tapping, pressing, kneading+tapping and knocking function will give your back complete massage.



- ✦ Speed adjustment: Three adjustable speeds for kneading, tapping, pressing, kneading+tapping and knocking, speed indicator will come on accordingly.



- ✦ Width adjustment: Three adjustable different width as 18/14/10cm for tapping, pressing and knocking.



- ✦ Roller's position adjustment: Adjust roller's up/down position to get fixed point massage.



- Air pressure massage (adjustable in auto and manual mode)

✦ Press "seat" key to start or stop air pressure massage in seat

✦ Press "Legrest" key to start or stop air massage in legrest.

✦ Press "Foot" key to start or stop air pressure massage in feet.

✦ Press "+/-" to choose massage intensity, There are 3 intensities for your choice.

✦ The corresponding indication will show on LCD screen.

✦ Press this key to weaken the intensity.

✦ Press this key to enhance the intensity.

✦ Slightly air pressure massage on hips and legs effectively fatigue muscles at the parts.

Operating Instruction and function illustration

- Now, introducing the use of massage chair briefly, as to retailed information, refer to "manual of remote control" part.

1. To use the chair after a complete check.

After turning on the power, if the massage rollers aren't in the storage position (top of the backrest), they will go up to the top area, the backrest will rise to sitting angle and the legrest will go down to the maximum lower position.



2. Press "ON/OFF" key

Press "on", the backrest will recline while the legrest will go up to comfortable position, time shows 15 mins.

3. Press the other keys in remote control to choose your favorite massage.

If you like stronger massage intensity, remove pillow or back cushion is helpful.

1. Automatic massage program

(close the remote control cover, it will work automatically)

- ✦ Suitable those who feel tired on wholebody.
- ✦ Suitable those who want simple massage.

2. Manual operating program

(Open the remote control cover to take manual massage)

- ✦ To choose any massage function or massage area by manual.

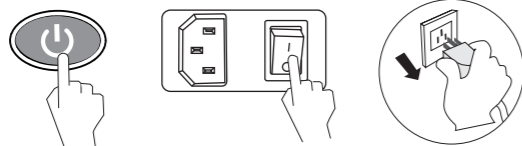
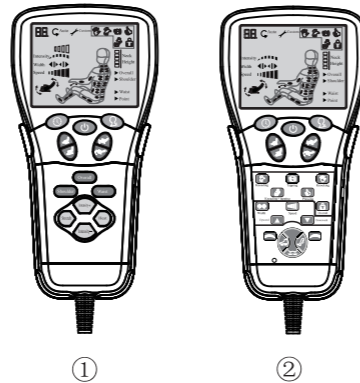

4. Turn off the power to stop work.

Press "ON/OFF" key to stop massage and massage rollers, backrest, legrest will go to the storage position. Turn off the power switch and take out the plug.

Operating Instruction and function illustration

● Moving

When moving the chair with castors:
Put the backrest at sitting angle.
Press the backrest from the top to move the chair slowly. Or raise the legrest & footrest and push the chair forward and backward with the castors. .



⚠ Note:

The power cable must be bonded and put on the seat to avoid any damage while moving the chair.

Please put down the chair slightly otherwise some parts may be damaged due to rough handling.

Don't use castor on uneven ground. .

Please don't push the chair on wood floor as the castor may scratch the floor, if needed, please carry the chair by two or more people working together.

● Tips:

1. Please don't operate the chair in damp area such as bathroom in case of electricity shock or other accident.

2. Please place the chair in a flat area.

3. Make sure to leave at least 40cm space backside.

4. Don't use the chair in direct sunlight or in a place of high temperature, material might fade or leather might harden.

5. The chair may cause abrasion to the floor. It's suggested to put the chair on a flat pad, by this you can also reduce noise while massage chair is working.



FAQ and troubleshooting data

Trouble	Possible reasons	Troubleshooting
The massager doesn't work after power on	Power cable is taken out of the plug	Inserting the power plug
	Power is off	Turn on the power
	Massage rollers are going up to the storage position	Don't operate the chair until the rollers go up to storage position
	The plug and socket are broken	Change plug and socket by manufacturer appointed dealer or qualified repairman.
	The fuse are broken	Change fuse with same specification
Massager can not go up/down, E1 indicator on the remote control screen is flashing.	Interior control circuit problem	Contact appointed professional for maintenance
	Overloading on massager causes interior circuit starts self-protection.	Reduce loading on the massager, turn off power and restart in 10 seconds.
	Interior structure is damaged so the circuit starts self-protection	Contact appointed professional for maintenance.
Massager stays at top or bottom position, Eb indicator on the remote control screen is flashing.	Fabric is broken, twist or prevent massage rollers from going up/down, so the circuit starts self-protection.	Contact appointed professional for maintenance.
	Limited switch doesn't work	Contact appointed professional for maintenance.
No kneading function meanwhile E2 indicator is flashing	Kneading motor or width inspection circuit problem	Contact appointed professional for maintenance.
No tapping function meanwhile E3 indicator is flashing	Tapping motor or width inspection circuit problem	Contact appointed professional for maintenance.
Noise becomes much louder	Long time working causes machine abrasion	Contact appointed professional for maintenance.
Remote control gets too hot	It's normal if the remote control is a little warm after long time operation, but it's abnormal if it is too hot	Contact appointed professional for maintenance.
Power cable or plug is too hot		Contact appointed professional for maintenance.



Attention: If the troubles are not caused by the above reasons, please turn off the power switch under the backrest, unplug the power and contact your dealer or the manufacturer for repair or maintenance.

Technical parameter

Name	massage chair	Voltage	200W
Model	HARMONY ZA-14	NW/GW(LBS)	157/183
Input voltage	<input type="checkbox"/> AC120V,60Hz <input type="checkbox"/> AC220V, 50/60Hz <input type="checkbox"/> AC240,60Hz	Packing size (INCH)	47x30x30
Safety class	I class		

Schematics of mechanical parts

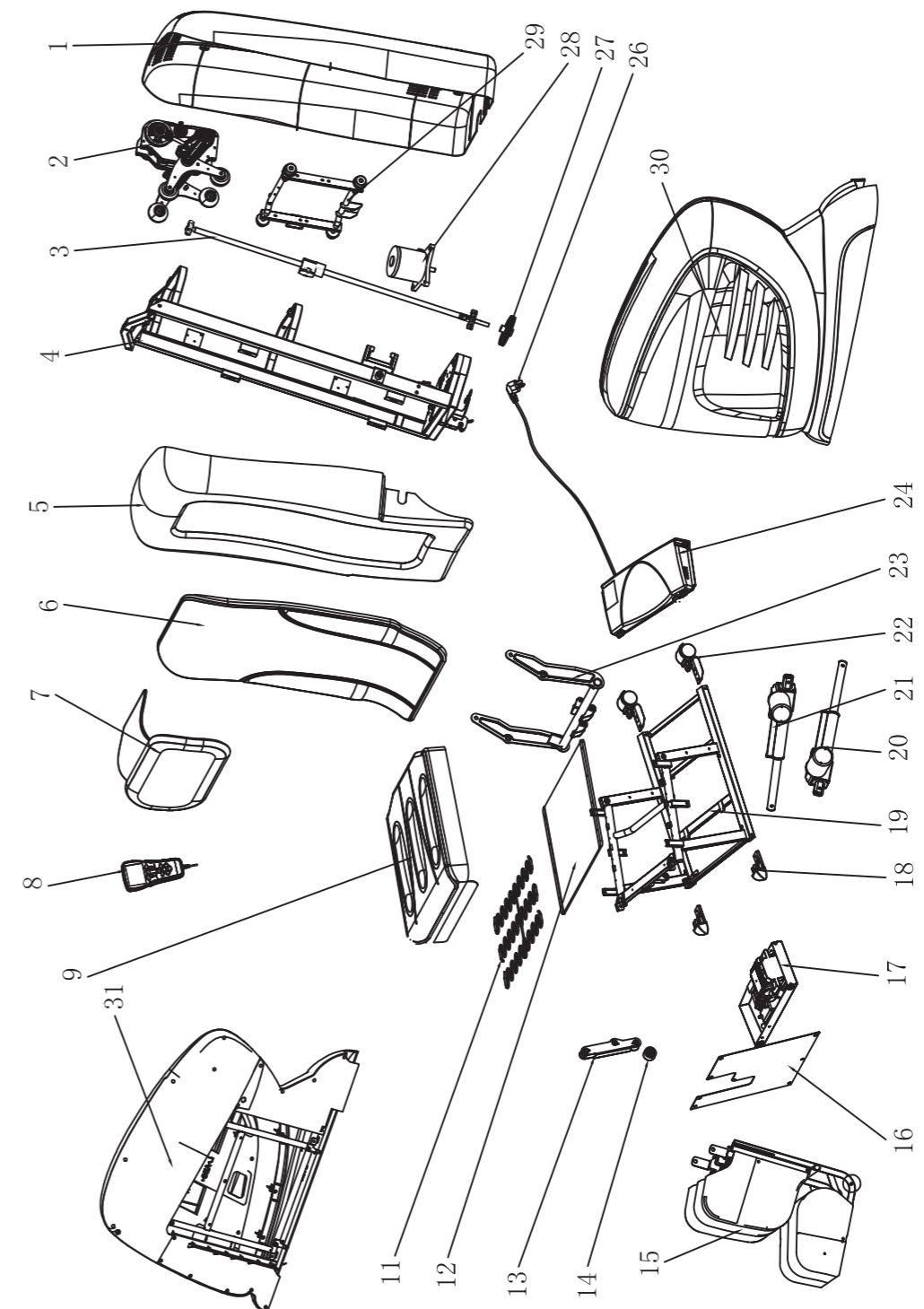

Mechanical parts list

No.	Name	Number	No.	Name	Number
1	Backrest cover	1	26	Power line	1
2	02 Massage machine	1	27	Screw pulley	1
3	Screw assembly	1	28	Up and down Motor	1
4	Backrest frame assembly	1	29	Core framework assembly	1
5	Front backrest assembly	1	30	left armrest assembly	1
6	Back mat	1	31	Right armrest assembly	1
7	Pillow	1			
8	Remote control	1			
9	Seat mat assembly	1			
11	S-shape spring	1			
12	Seat cloth	1			
13	Legrest connect board	1			
14	Roller	1			
15	Legrest assembly	1			
16	Front cover board	1			
17	Air pump tray assembly	1			
18	Front foot mat	1			
19	Seat frame assembly	1			
20	Backrest electric actuator	1			
21	Legrest electric actuator	1			
22	Wheel	1			
23	Backrest turning frame	1			
24	Power box	1			